

## TECHNICAL CHARACTERISTICS

### 1. General Characteristics

Dimension: 11.30L x 7.62W x 5.50H mm  
 Weight: Approx. 0.32 g  
 Contact principle: Friction technology  
 Operating position: Shaft up / Down / Horizontal  
 Mounting System: SMT Type (without post)  
 Durability: 10,000 cycles min.

### 2. Mechanical Characteristics

Insulation material: Thermoplastic, UL 94V-0  
 RoHS Directive 2011/65/EU Compliant

### 3. Electrical Characteristics

Number of contacts: 6 pins  
 Contact resistance: 50 mΩ typical, 100 mΩ max.  
 Insulation resistance: >1000 MΩ / 500 VDC

### 4. Solderability

Wave: Not applicable  
 IR reflow: 260°C, 10 sec. Max.  
 Manual soldering: 360°C, 3 sec. Max.

### 5. Environmental Characteristics

Operating temperature: - 40°C ~ + 85°C  
 Operating humidity: 10 % ~ 95 % RH  
 Storage temperature: - 40°C ~ + 85°C  
 Storage humidity: 10 % ~ 95 % RH

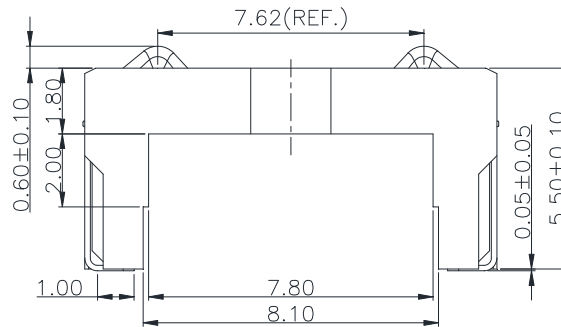
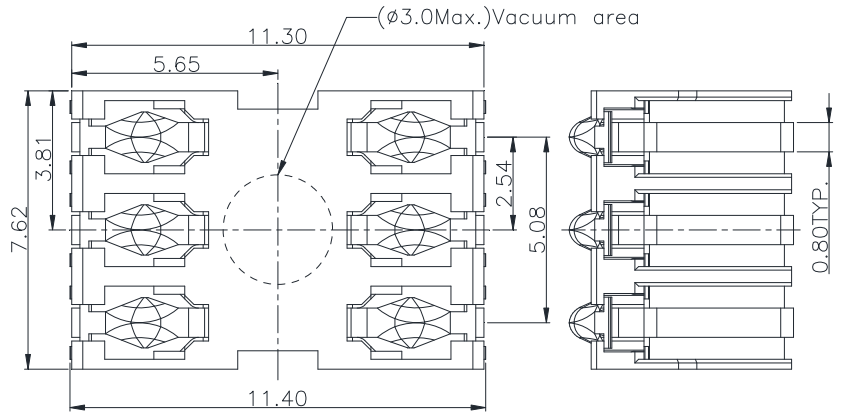

Recommend card slot height: 1.0 mm

Unit: mm; Tolerances: ±0.15 mm

Mechanical outline dimension

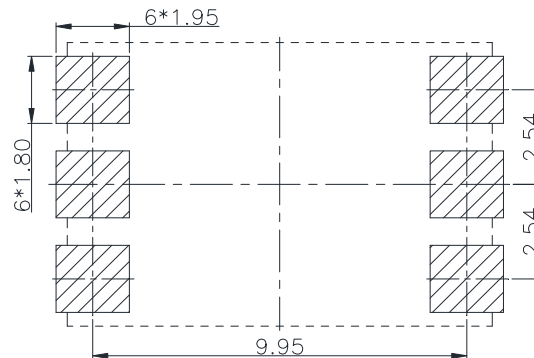

Unit: mm; Tolerances: ±0.05 mm

Reference dimension for PCB layout

H&V Smart Card Connector

Model No.: ICC-409 Type2

Revision: 1.0

Date: MAY 03, 2017

Note:

1. Coplanarity of solder pins 0.10mm max.
2. Recommended thickness of solder paste > 0.15mm.